

# Workbench True Value Center

SWC Las Palmas & Ward, Patterson, CA.

## NOW LEASING

- ❖ 12,960 SF Retail Center
- ❖ Anchored By:  
True Value Hardware

For information contact:

Tim Bettencourt

(209)521-1591

[www.cosol.net](http://www.cosol.net)



CoSoL Commercial Real Estate





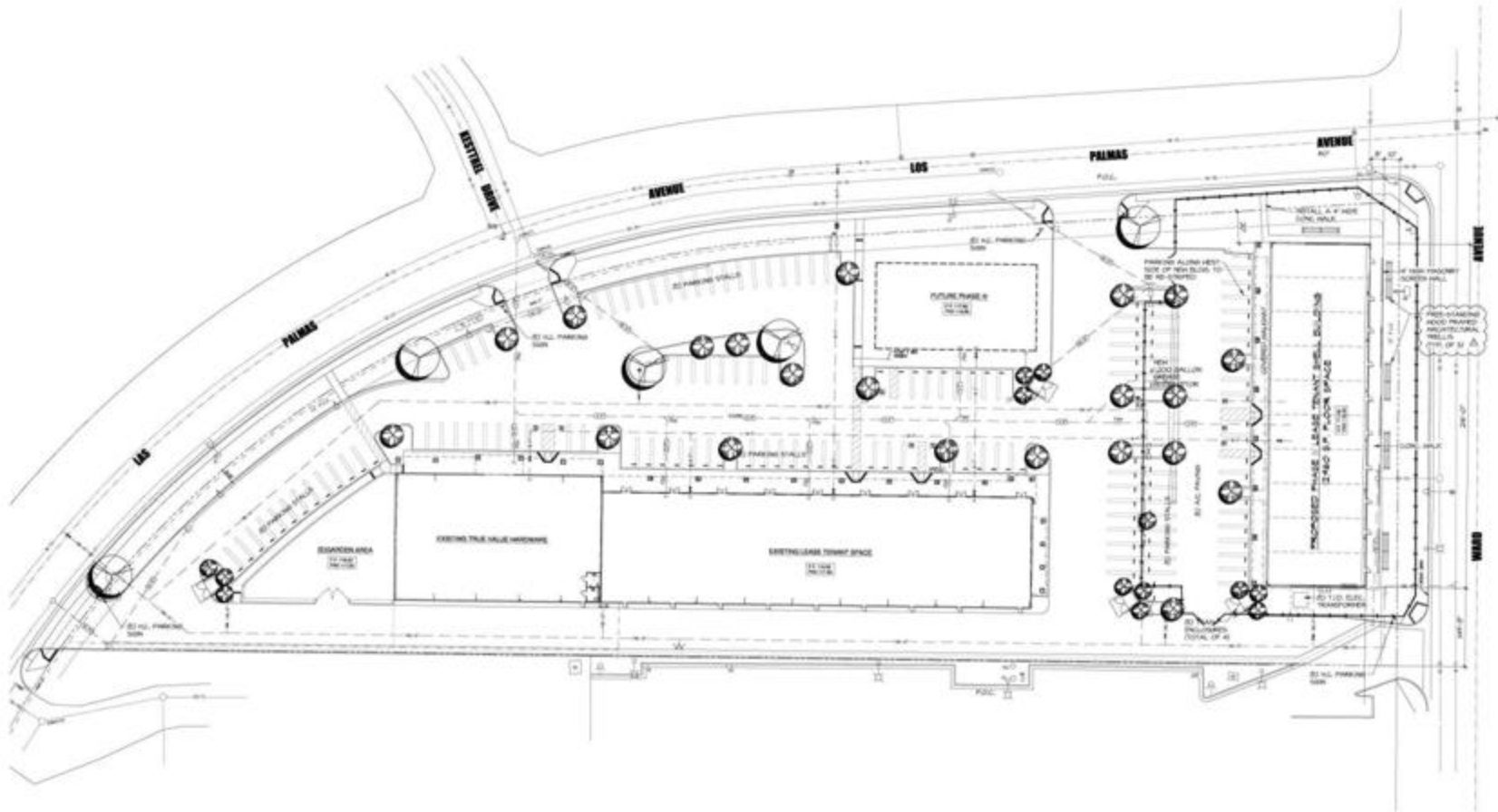

**SITE PLAN**



PROPOSED LEASE TENANT BUILDING FOR  
**WORKBENCH TRUE VALUE CENTER**  
 PATERSON, CALIFORNIA

Park G. Ingram  
 ENGINEERING

11555 Sierra Blvd, Suite 100  
 San Diego, CA 92127  
 Tel: 619.451.2022  
 Fax: 619.451.2023  
 www.pgingram.com



**MODERN STEEL STRUCTURES**

The Industry's Most Innovative of Pre-Engineered Metal Structures®

10000 S. Bascom Avenue, Suite 100  
 San Jose, CA 95128  
 Tel: 408.261.1000  
 Fax: 408.261.1001  
 www.mss.com

REVISIONS	DATE	BY	CHKD
1	07/20/10	PI	PI
2	07/20/10	PI	PI
3	07/20/10	PI	PI

OWNER	0750
DATE	07/20/10
SCALE	
PROJECT	

**SP1**