

FOR LEASE

4028 DALE ROAD, SUITE 101
MODESTO, CA.



1,835 Square Feet Professional Office Available

Ample Parking / Medical Uses Accepted

\$2.00 psf NNN

Highly Visible Northwest Modesto Location

Could be Executive Office space

FOR FURTHER INFORMATION CONTACT:

Tim Bettencourt—tbettencourt@cosol.net

Janet Akard—jakard@cosol.net

Jake Maiorino—jmaiorino@cosol.net

(209) 521-1591

www.cosol.net

FLOOR PLAN AND MAP

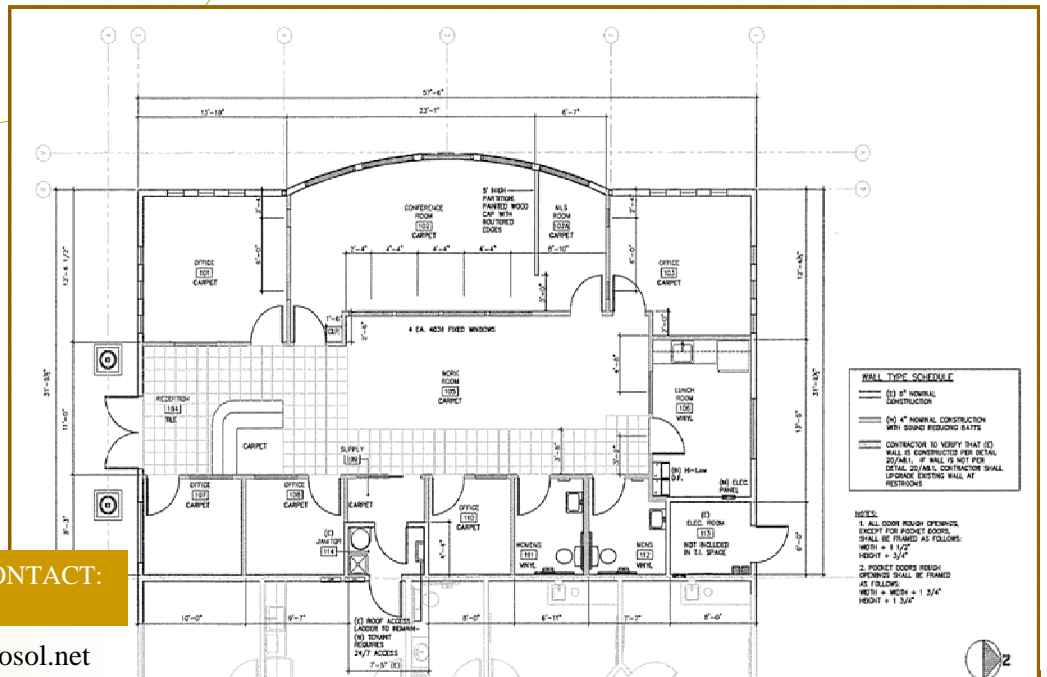

FOR FURTHER INFORMATION CONTACT:

Tim Bettencourt—tbettencourt@cosol.net

Janet Akard—jakard@cosol.net

Jake Maiorino—jmaiorino@cosol.net

(209) 521-1591

www.cosol.net

